

MIRROR LAKE VILLAGE AT FRUITLAND PARK

805 Lemon Avenue, Fruitland Park, FL 34731

ASK ABOUT
**SPECIAL OFFERS
AND INCENTIVES**

LOW INTEREST RATE SPECIAL!



Spirit II

Homesite #2- 156

\$329,350

1,713 ft ²	3	2.5	2

LOW INTEREST RATE SPECIAL!



Evolve

Homesite #2- 131

\$321,700

1,662 ft ²	3	2	2

LOW INTEREST RATE SPECIAL!



Excite

Homesite #2- 128

Was ~~\$324,480~~
NOW \$316,630

1,520 ft ²	3	2	2

LOW INTEREST RATE SPECIAL!



Evolve

Homesite #2- 133

Was ~~\$339,990~~
NOW \$323,410

1,662 ft ²	3	2	2

LOW INTEREST RATE SPECIAL!



Prosper

Homesite #2- 100

Was ~~\$323,170~~
NOW \$316,970

1,647 ft ²	4	2	2

LOW INTEREST RATE SPECIAL!



Delight

Homesite #2- 98

Was ~~\$328,900~~
NOW \$317,510

1,501 ft ²	4	2	2

Sitemap

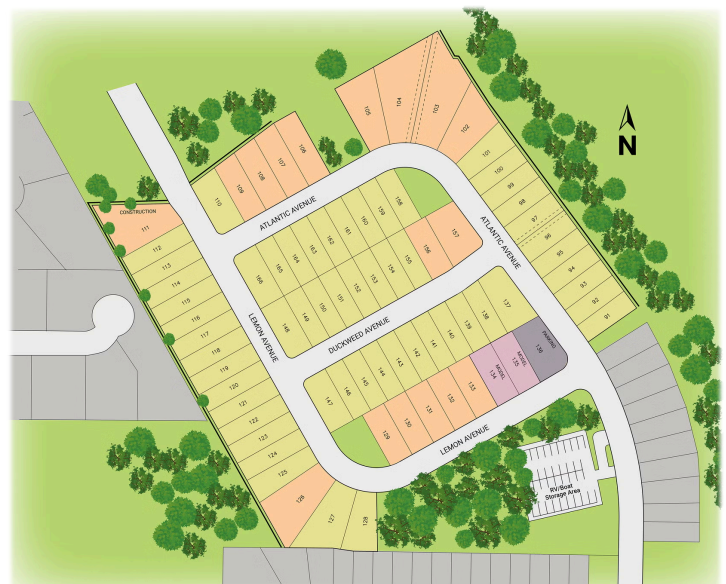

LOW INTEREST RATE SPECIAL!



Spirit

Homesite #2- 97

\$318,560

1,713 ft ²	3	2.5	2

LOW INTEREST RATE SPECIAL!



Delight

Homesite #2- 154

\$295,510

1,501 ft ²	4	2	2



Document generated on
10.5.2025

Programs, rates, program terms and conditions subject to change without notice. Not all products are available in all states or for all amounts. Other restrictions and limitations apply. This is not a commitment to lend. Builder's offer terms are subject to change without notice. This Park Square Homes site plan is based on current development plans which are subject to change without notice. Access to and rights to use certain areas may be restricted. The existing zoning of any surrounding property or potential uses of any tract of land or any parcel of land adjacent the Park Square Homes community in which the property is located is based on current development and subject to change without any further notice. Pictures, photographs, colors, features, and sizes are for illustration purposes only and will vary from the homes as built. This material shall not constitute a valid offer in any state where prior registration is required or if void by law. See New Home Counselor for details.
CRC 1330351 CGC 1520474



Available Dream Homes

844.774.4636

ParkSquareHomes.com

MIRROR LAKE VILLAGE AT FRUITLAND PARK

805 Lemon Avenue, Fruitland Park, FL 34731

ASK ABOUT
SPECIAL OFFERS
AND INCENTIVES



Prosper

Homesite #2- 122

\$322,790

1,647 ft ²	4	2	2



Delight

Homesite #2- 96

Was ~~\$321,990~~
NOW \$317,590

1,501 ft ²	4	2	2



Document generated on
10.5.2025

Programs, rates, program terms and conditions subject to change without notice. Not all products are available in all states or for all amounts. Other restrictions and limitations apply. This is not a commitment to lend. Builder's offer terms are subject to change without notice. This Park Square Homes site plan is based on current development plans which are subject to change without notice. Access to and rights to use certain areas may be restricted. The existing zoning of any surrounding property or potential uses of any tract of land or any parcel of land adjacent the Park Square Homes community in which the property is located is based on current development and subject to change without any further notice. Pictures, photographs, colors, features, and sizes are for illustration purposes only and will vary from the homes as built. This material shall not constitute a valid offer in any state where prior registration is required or if void by law. See New Home Counselor for details.
CRC 1330351 CGC 1520474